

Grundstücksgrenze

Nachbarbebauung

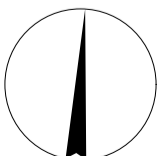
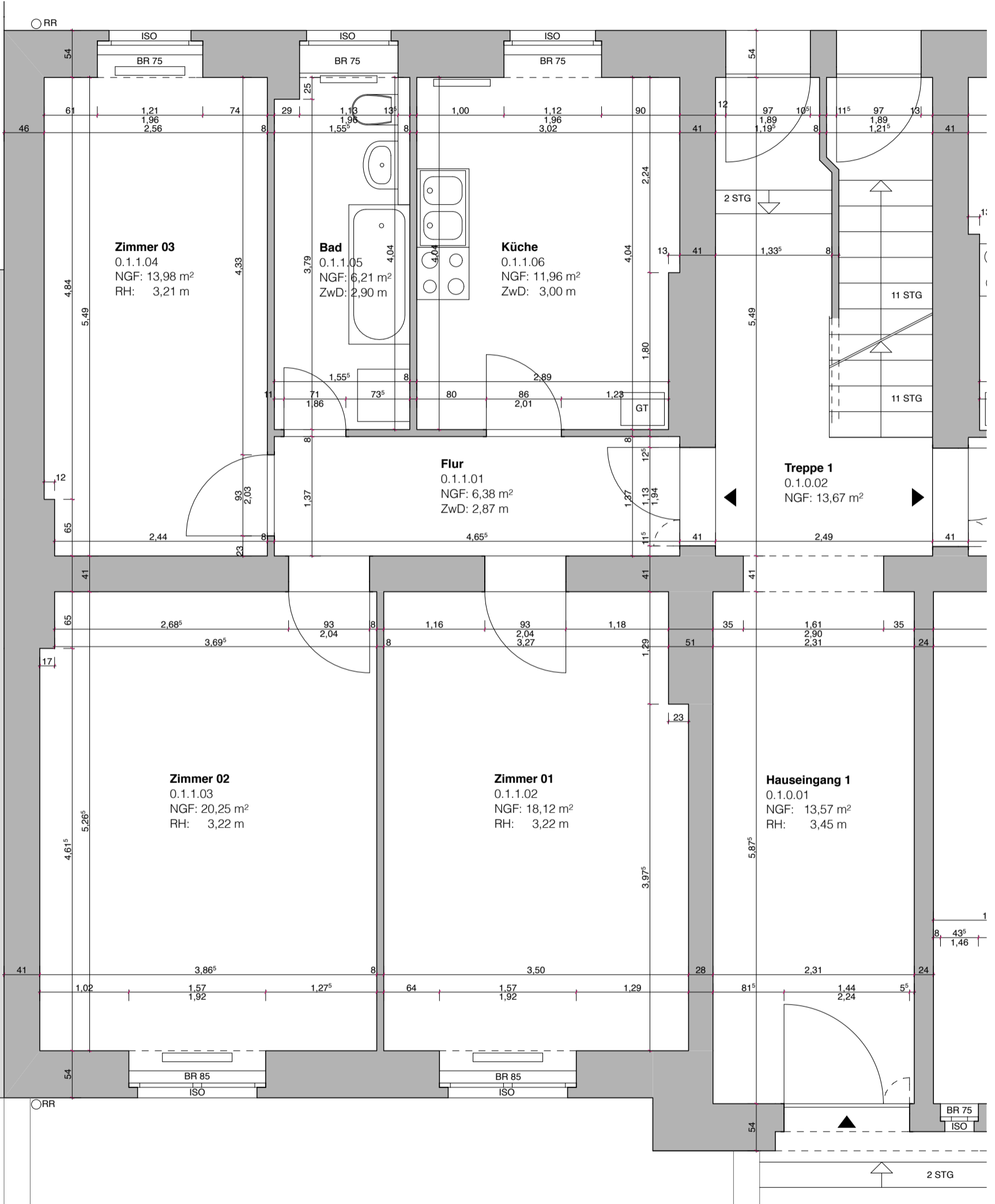

Berliner Str. 43 / Biedenkopf Str. 2-4, 13507 Berlin-Tegel
Grundriss Erdgeschoss - TOP 26

archimes
Michael Pek • Knaackstraße 23-25 • D-10405 Berlin • TEL +49.30.44 11 646 • MOB +49.1522.860 8020

e-mail: archimes@online.de

Bestand
Wohnhaus

Maßstab
1:50

ZN

BER43

1.0.1.01

PM 28.01.13

a

b

c